

# Echelon<sup>®</sup>

CABINETRY

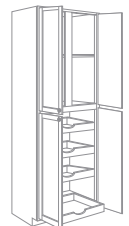

**Homeowner Documentation** | April 2018

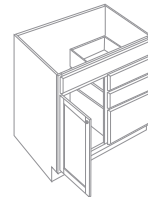
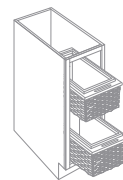
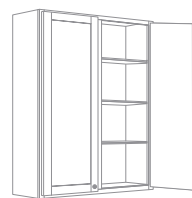

## CARING FOR YOUR NEW WOOD ECHELON CABINETY PRODUCTS

Congratulations! We know you have a choice in selecting kitchen cabinetry and appreciate your interest in our brand. With proper care, your Echelon Cabinetry products will deliver years of beauty, enjoyment, and convenience.

This Echelon Cabinetry Care Guide will assist you in choosing the correct products to protect your cabinets from normal wear and to repair any imperfections if they should occur.

Echelon Cabinetry products are constructed of quality materials and finished with superior coatings. They have undergone rigorous testing prior to shipping. This is your assurance that Echelon Cabinetry products will maintain their attractive finish and structural soundness throughout the years of normal everyday use.

As with any product constructed of wood, taking the time to care for your new cabinets can go a long way in keeping them looking their best. Here are a few simple suggestions to make your cabinet care easier.

- Clean cabinets as needed with a mild detergent or with soap and water (Murphy's Oil Soap) and dry well using a lint-free cloth for both washing and drying.
- Wipe up spills, splatters and water spots as they occur, keeping cabinets and countertop surfaces dry.
- Give special attention to areas near the sink and dishwasher that come in contact with moisture.
- Use cleaners and polishes designed for wood cabinets and clean all surfaces as needed.

## STOPPING PROBLEMS BEFORE THEY OCCUR

Do not use abrasive cleaners, scouring pads, or powdered cleaners. These materials may penetrate the cabinet finish allowing moisture to enter and cause deterioration.

- **Do not** use aerosol sprays containing silicones or paste waxes.
- **Do not** leave a wet cloth on or near cabinets for extended periods of time.
- **Do not** allow oven cleaners or other caustic cleaners to touch the cabinets.
- **Do not** spray or clean cabinets with glass cleaners.

## REMEDIES FOR COMMON KITCHEN ACCIDENTS

Most problems can be prevented by wiping up any spills as soon as they occur. Follow these first aid suggestions for common household accidents. When removing a spot begin at the outer edge and work toward the middle to prevent the spot from spreading.

### ***Food Spots/Water Spots***

Clean cabinets as needed with a mild detergent or with soap and water (use sparingly) and dry well using a lint free cloth for both washing and drying.

### ***Greasy Spots***

Rub grease, lipstick, crayon, or oil with a damp cloth. Use cleaners and polishes designed for wood cabinets and clean all surfaces as needed.

### ***Chewing Gum/Candle Wax***

Apply a plastic bag filled with ice on top of the deposit until it is brittle enough to crumble off.

### ***Minor Scratches, Nicks, and Dents***

Echelon Cabinetry offers a Cabinetry Care Kit to help you keep your Echelon Cabinetry products looking like new. Most scratches, nicks, and dents can be repaired using this kit. The Cabinetry Care Kit includes (1) a touch-up marker to re-stain small scratches and (2) a putty stick to fill nail holes, minor nicks, and dents.

Customers who need to re-stain larger areas of a cabinet may also order a quart of touch-up stain.

Both of these items can be ordered through your local Echelon Cabinetry dealer or the Echelon Cabinetry customer service department.

## 6-WAY SELF-CLOSE HINGE ADJUSTMENT

1

### Side Adjustment

+ / -1.5mm (1/16")

Rotate adjustment screw

2

### Height Adjustment

+ / -2mm (3/32")

Loosen screw, align door, tighten screw

3

### Depth Adjustment

+ 2.5mm (7/64"), -.05mm (1.32")

Rotate cam screw

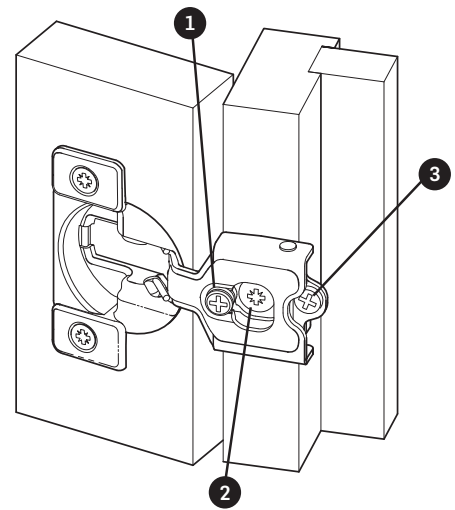

### Mounting Screws

Hinge cup to door, No. 6 x 5/8" Flat Head screw  
Base plate to face frame, No. 10 x 3/4" Pan Head screw

## GENTLE-TOUCH SOFT-CLOSE HINGE ADJUSTMENT

### Innovative Three Tiered Adjustment

These three levels of adjustment provide a different level of resistance on the damping system in the soft-close mechanism.

The settings can be adjusted differently for each Gentle Touch Hinge on the door so you can personalize the closing resistance to meet your closing preferences regardless of the size and weight of the door.

**NOTE: Hinges come factory set at the highest lever of resistance. To change the resistance from any other setting, move the adjustment switch to 'Strong' first, then to the desired resistance level. Close the door and the soft-close will reset to the new selected resistance.**



## SOFT-CLOSE MECHANISM ADJUSTMENTS



### STRONG

This setting of resistance provides a slow, smooth closing action. This level will accommodate larger heavier doors.



### MEDIUM

To achieve less resistance.



### LIGHT

To achieve the least amount of resistance.

**DYNAPRO – UNDERMOUNT SOFT-CLOSE DRAWER GUIDE ADJUSTMENTS**

**SIDE  
ADJUSTMENT**

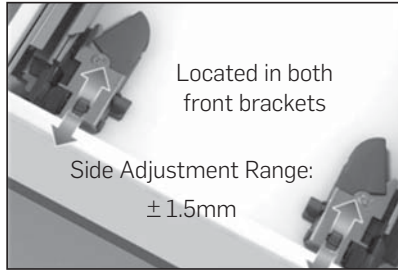

Located in both  
front brackets

Side Adjustment Range:  
 $\pm 1.5\text{mm}$

**HEIGHT  
ADJUSTMENT**

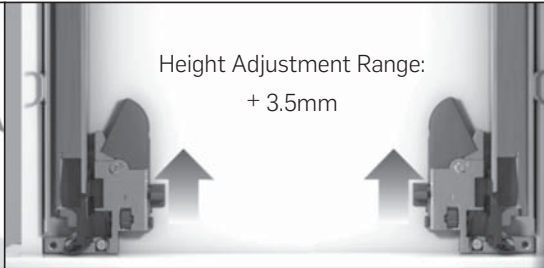

Height Adjustment Range:  
 $+ 3.5\text{mm}$

## ECHELON CABINETRY WOOD CHARACTERISTICS

Thank you for your decision to purchase Echelon Cabinetry. We know you have a choice in selecting cabinetry and we appreciate your interest in our brand. Below is a summary of what you can expect from your new cabinets.

### BIRCH

Birch is a close-grained hardwood. The grain is often straight but can also come in wavy or curly patterns. Sapwood is typically white; heartwood is a light reddish-brown.

### CHERRY

Cherry is a strong hardwood with a fine to medium grain pattern. Cherry is a multi-colored hardwood which may contain small knots and pin holes. The sapwood is typically white to yellowish; heartwood is deep reddish brown. Cherry begins to darken from the moment it is cut, and continues to darken over time. This distinctive characteristic is one of many reasons cherry has been the choice of fine furniture makers for centuries.

### MAPLE

Maple is a heavy and strong hardwood. Though it typically has a close, uniform grain pattern, there may be unique characteristics such as bird's eye or tiger stripe grain patterns or mineral streaks. Maple is predominantly off-white, although it may contain hues of yellow-brown and pink. It stains and finishes beautifully, making it a popular choice for cabinetry.

### OAK

Oak is a mostly straight-grained, durable hardwood with a medium to coarse texture. The sapwood is white to light brown; heartwood is pinkish red brown. It is sometimes streaked with green, yellow, and black mineral deposits. The open grain produces dramatic and distinct patterns.

### PAINTED

Painted cabinets use a combination of hardwood and engineered materials, such as MDF, to create a beautifully finished product. On painted Salerno & Touraine doors, some of the grain pattern and other characteristics, such as mineral streaks, pitch pockets, checks and pin knots, will remain visible through the painted finish. The finish will take on the texture of birch graining characteristics and will not have a filled smooth surface.

### THERMOFOIL

Rigid vinyl thermofoil is heat- and pressure-bonded to the face and edges of these sculpted doors while the back of the doors are covered with low-pressure white melamine. Heat shields are highly recommended when using thermofoil to minimize potential discoloration and delamination.

### CABINETRY CARE

To keep your Echelon Cabinetry products looking their best for years to come we recommend:

- Clean cabinets as needed with a mild soap and water, and dry well using a lint-free cloth for both washing and drying.
- Wipe up spills, splatters and water spots as they occur.
- Use cleaners and polishes designed for wood cabinets, and clean all surfaces as needed.

### NATURAL CHARACTERISTICS & ENVIRONMENTAL FACTORS

The wood used in Echelon Cabinetry showcases the natural beauty that comes from the inherent characteristics of wood, including:

- Differences in color hues, grain patterns, and textures
- Differences between open- and closed-grain sections
- Visible joint lines, mineral streaks, worm tracks, etc.

Due to nature's infinite variations, it is impossible to include every possible wood characteristic. These variations can occur from cabinet to cabinet and within the same door or drawer front; however, they are considered natural characteristics, not defects. More details about acceptable wood variation and characteristics can be found in the Echelon Cabinetry Visual Quality Standards Training Guide.

As cabinetry products age, the finish may mellow or discolor slightly. The degree of change to the original finish color is affected by your products' exposure to natural and artificial light, smoke, and chemicals. This is a normal characteristic of furniture and cabinetry and not considered a quality defect.

These natural and environmental factors are considered normal characteristics of wood and not defects. Echelon Cabinetry cannot be held responsible for naturally occurring changes experienced by the wood used in your cabinets.

## PAINTED FINISH DISCLOSURE

Echelon Cabinetry painted and glazed finishes are applied using the same quality standards as all of our other finishes. Painted cabinet products have unique characteristics that differ from other finishes but are not considered manufacturer quality defects:

- Wood of all species is hygroscopic, meaning that it is subject to the humidity and temperature of its environment. It will lose or gain moisture and consequently shrink or swell depending on the environment. Even protective coatings cannot prevent this movement; they merely impede the process. As humidity increases, the moisture content increases, and wood expands. As humidity decreases, the moisture content decreases, and the wood will actually shrink. Therefore, painted wood cabinetry should be expected to "shift" during the various shifts in weather throughout the year. Changes in temperature that naturally occur from season to season (especially humidity or prolonged moisture) will cause movement in hardwood products, such as hairline cracks, peeling, or separation. These types of movement are widely accepted as normal in the kitchen cabinet industry and not considered quality defects. Wood may expand and contract differently from cabinet to cabinet and from joint to joint within the same cabinet. Consequently, some cabinet joints may not show any effects of humidity, while others may show varying degrees of cracking or peeling. These shifts may also occur due to the repeated impacts from normal everyday use.
- Painted cabinets use a combination of hardwood and engineered materials, such as MDF, to create a beautifully finished product. On painted Salerno and Touraine doors, some of the grain pattern and other characteristics such as mineral streaks, pitch pockets, checks and pin knots, will remain visible through the painted finish. The finish will take on the texture of birch graining characteristics and will not have a filled smooth surface.
- As painted cabinet products age the finish may mellow or discolor slightly. The degree of change to the original finish color is affected by your products' exposure to natural and artificial light. This is a normal characteristic of painted furniture and cabinetry and not considered a quality defect.

Due to these natural and environmental factors, Echelon Cabinetry cannot be held responsible for naturally occurring changes experienced by the wood in our cabinets.

*See the back of this specification book for the Echelon Cabinetry Product Disclosure form. Tear it out and make copies to issue to your customers. These disclosure forms are designed to be signed by the end consumer and kept in your records. Painted finish disclosure acknowledgement forms do not need to be included with your orders or submittals.*

## HUMIDIFICATION AND WARPED DOOR DISCLAIMER – RELATING TO WOOD PRODUCTS

The natural process of expansion and contraction occurring in wood cabinets is not new or exclusive to ACPI cabinetry. Wood of all species is hygroscopic, meaning that it is subject to the humidity and temperature of its environment. It will lose or gain moisture and consequently shrink or swell depending on the environment. This process can affect your cabinetry doors, drawers, and face frames. Even protective coatings cannot prevent this movement; they merely impede the process.

As humidity increases, the moisture content increases, and wood expands. As humidity decreases, the moisture content decreases, and the wood will actually shrink.

As an example, if the wood product is measured to have a moisture content of 10% and is exposed to 25% relative humidity, one can expect the wood to dry to 5% moisture content and shrink as it dries.

The only way to accurately predict wood movement is to know the moisture content of the material when you receive it. Moisture content is measured using a moisture meter.

Wood may expand and contract differently from cabinet to cabinet and from joint to joint within the same cabinet. Therefore, painted & stained wood cabinetry should be expected to "shift" during the various shifts in weather throughout the year.

Changes in temperature that naturally occur from season to season (especially humidity or prolonged moisture) will cause movement in hardwood products, such as hairline cracks or separation. These issues are more common near joint areas and panel components.

MOISTURE CONTENT VS. RELATIVE HUMIDITY	
RELATIVE HUMIDITY	MOISTURE CONTENT
0%	0%
25%	5%
50%	9%
75%	14%
99%	23-30%

Source: <http://www.forestprod.org/cdromdemo/wd/wd4.html>

### COMMON EFFECTS TO JOINTS AND PANELS DUE TO TEMPERATURE FLUCTUATION

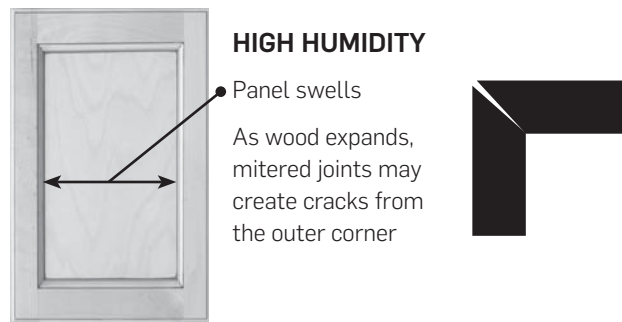
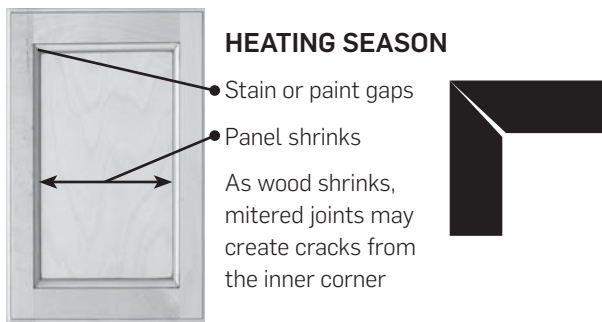

Homes in most of the U.S. that lack humidity control typically experience interior levels of humidity from 25% relative humidity to 65% relative humidity. This range of humidity will cause a 6% change in the moisture content of the wood.

Source: [http://www.woodweb.com/knowledge\\_base/A\\_Finish\\_Carpenters\\_Guide\\_to\\_Understanding.html](http://www.woodweb.com/knowledge_base/A_Finish_Carpenters_Guide_to_Understanding.html)

Wood products, especially cabinet doors and drawer fronts, absorb excess moisture in the air and can expand. Often the wood will return to normal as the moisture in the air subsides. However, there are instances where door warpage may occur. A door is best tested for warping issues following a complete heating and cooling season. To test a door, place it face-down on an even, flat surface and measure the gap between the surface and the door edge to the nearest 1/16".



## acpi WARP SPECIFICATIONS

Door Warpage:  $<1/16$ " per lineal foot,  $<1/8$ " maximum warp

Door Twist: Allow  $1/8$ " maximum warp, one corner up, three corners down allowed

Warping of doors, drawers, and face frames are caused by the climate surrounding the product and are not considered defects. However, we recognize that this is a sensitive issue during new home and remodel construction projects. Products need to acclimate to their environment under normal HVAC conditions for a period of at least 60 days to properly settle. If after 60 days there remain signs of warping as outlined above, please contact customer service for a replacement door. Following this 60 day acclimation period, acpi will replace warped doors and drawer fronts within the first 180 days from the date of purchase. Products more than 180 days past purchase date or showing signs of warping less than the guidelines above are not considered warrantable and are not covered by this policy.

Improper storage can cause minor changes to the size of these materials. These changes in size that occur due to this environment are not covered by ACPI warranty. Therefore, we encourage you to take the following precautionary steps to help protect your cabinets from changes in humidity.

- Never store cabinets in a moist environment.
- Wipe off any excess moisture from cabinet surfaces as soon as possible.
- Store and install cabinets in a dry and conditioned environment. If you are installing product that has recently been transported, it may take a little while for the wood to acclimate to its new climate humidity – some expansion or shrinkage may occur.  
**NOTE: hinge adjustments may be required to improve the fit of the door during this process. See pages 12.14 -12.15.**
- Monitor the humidity inside the home. Reasonably accurate digital thermometer-hygrometer units are available to measure humidity. Wood will continue to equalize with the surrounding moisture content found in the air despite a finish. It takes several days to several weeks before the wood returns to normal after any correction in the environment.
- Improperly adjusted hinges may cause a door to appear warped. A hinge-adjustment may improve the fit of the door. See pages 12.14-12.15 for hinge adjustment tips.

These steps will help hinder the effect of humidity on your cabinets; however, there is no process to prevent these effects entirely.

Please reference our Cabinetry Care guidelines for additional information ways to maintain the beauty and integrity of your ACPI cabinets for years to come.

## LIMITED LIFETIME AND LIMITED 5-YEAR WARRANTY

### For cabinetry purchased on or after April 1, 2016.

ACProducts, Inc. (ACPI) warrants to the original consumer purchaser that our Echelon Cabinetry will be free from defects in material and workmanship under normal use for a period of five (5) years from the date of purchase or as per written agreement. This warranty is extended to the original purchasing consumer only for use of the product within the United States and is not transferrable. No changes or modifications can be made to this warranty except by an officer of ACProducts, Inc.

### WARRANTY COVERAGE

**Limited 5-Year Warranty on Cabinets** to the original purchasing consumer from date of original purchase or as per written agreement that the cabinets will be free from defects in material and workmanship under normal use.

**Limited Lifetime Warranty on Drawer Guides and Hinges** to the original purchasing consumer as long as they own the product that the drawer guides and hinges shall be free from defects in material and workmanship under normal use.

### WARRANTY LIMITATIONS AND EXCLUSIONS

- This Warranty does not apply to (i) damage caused by improper installation, (ii) other product used or installed in connection with the cabinets including, but not limited to, appliances, countertops, or plumbing fixtures (including the costs to remove and reinstall such other product), (iii) product damage, loss, or theft either after delivery for material only jobs or after installation for installed jobs, or (iv) damage caused by misuse, abuse, neglect, accident, alteration, improper use, exposure to moisture or extreme temperatures, failure to maintain, acts of God, or normal wear and tear.
- Naturally occurring wood characteristics including, but not limited to, variations in color, grain pattern, mineral streaks and knots are not considered defects. Color variations may also be affected by age, character of cabinets, and exposure to UV light, sunlight, smoke, household cleaners, and other environmental conditions. As such, new and/or replacement cabinets may not match display samples and/or existing cabinets. Any such variations and changes to Echelon Cabinetry products, whether present during production or which develop over time, are not considered quality defects and are not covered by this warranty.
- Painted finishes have unique characteristics that differ from standard wood finishes. Wood of all species is subject to the humidity and temperature of its environment and may expand or contract due to changes in weather, temperature, or climate. Due to these normal shifts in the environment, painted wood cabinetry may develop hairline cracks, peeling, or separation or seam lines. On select hardwoods and veneers, joints, seams, and some natural characteristics of the wood (including, but not limited to, grain patterns, knots, and mineral streaks) will remain visible through painted finishes. As painted cabinet products age, the finish may mellow or discolor slightly. The degree of change to the original finish color is affected by the products' exposure to natural and artificial light. These normal variations are not considered quality defects and are not covered by this warranty.



### WARRANTY PERFORMANCE

In the event of a manufacturing defect within the terms and conditions set forth herein, ACPI will repair or replace the product, at ACPI's sole option, without charge. Such repair or replacement is contingent upon the current product offerings within the ACPI product line at the time of the warranty claim. If the affected product is no longer available, ACPI reserves the right to (i) replace the affected component with a new component of the same style, or (ii) replace the affected component and any other component within the total product to achieve a uniform appearance with a similar and comparable product style and quality as the original product. Due to changes that occur during the wood's natural aging process, ACPI cannot guarantee that replacements will exactly match the finish and appearance of the remaining components in the original product. ACPI will not provide or pay for the cost of (i) removal of defective product, (ii) transportation of defective, repaired, or replaced product, or (iii) installation of repaired or replaced product. Repaired or replaced product shall be warranted for a period equal to the remainder of the original Limited Warranty on the original product or for ninety days, whichever is longer.

### WARRANTY DISCLAIMER

**THIS LIMITED WARRANTY SETS OUT THE FULL EXTENT OF ACPI'S RESPONSIBILITIES, AND THE EXCLUSIVE REMEDY REGARDING THE PRODUCTS. ALL IMPLIED WARRANTIES, INCLUDING WITHOUT LIMITATION, IMPLIED WARRANTIES OF MERCHANTABILITY AND FITNESS FOR A PARTICULAR PURPOSE, ARE LIMITED TO THE DURATION OF THIS LIMITED WARRANTY. IN NO EVENT SHALL ACPI BE LIABLE FOR DAMAGES IN EXCESS OF THE PURCHASE PRICE OF THE PRODUCT OR FOR, WITHOUT LIMITATION, COMMERCIAL LOSS OF ANY SORT; LOSS OF USE, TIME, DATA, REPUTATION, OPPORTUNITY, GOODWILL, PROFITS OR SAVINGS; INCONVENIENCE; INCIDENTAL, SPECIAL, CONSEQUENTIAL OR PUNITIVE DAMAGES; OR DAMAGES ARISING FROM THE USE OR INABILITY TO USE THE PRODUCT. SOME STATES AND JURISDICTIONS DO NOT ALLOW LIMITATIONS ON HOW LONG AN IMPLIED WARRANTY LASTS, OR THE DISCLAIMER OR LIMITATION OF INCIDENTAL OR CONSEQUENTIAL DAMAGES, SO THE ABOVE LIMITATIONS AND DISCLAIMERS MAY NOT APPLY TO YOU.** All disputes with ACPI arising in any way from this Limited Warranty or the sale, condition or performance of the Products shall be resolved exclusively through final and binding arbitration, and not by a court or jury.

### SEVERABILITY

If any portion of this Limited Warranty is held to be illegal or unenforceable, such partial illegality or unenforceability shall not affect the enforceability of the remainder of the Limited Warranty.

### CLAIMS

All claims must be submitted in writing and must specify the defects present in the cabinets and accessories. To initiate a claim for defective cabinets and accessories contact your builder, dealer, distributor or contractor who installed and sold the product. If that party is unknown or you have difficulty obtaining assistance, contact:

ACProducts, Inc., Customer Service Dept., 3551 Plano Parkway, Suite 200, The Colony, Texas 75056

After ACPI has had an opportunity to inspect the cabinets and accessories, they will, at their discretion either replace defective cabinets and accessories or repair any defects in the cabinets and accessories.

*For warranty information on cabinetry purchased between November 1, 2012 and March 31, 2016, please visit [www.echeloncabinetry.com/warranties](http://www.echeloncabinetry.com/warranties).*

©2016 ACPI All rights reserved.

## ECHELON CABINETRY WOOD CHARACTERISTICS

Thank you for your decision to purchase Echelon Cabinetry. We know you have a choice in selecting cabinetry and we appreciate your interest in our brand. Below is a summary of what you can expect from your new cabinets.

### BIRCH

Birch is a close-grained hardwood. The grain is often straight but can also come in wavy or curly patterns. Sapwood is typically white; heartwood is a light reddish-brown.

### CHERRY

Cherry is a strong hardwood with a fine to medium grain pattern. Cherry is a multi-colored hardwood which may contain small knots and pin holes. The sapwood is typically white to yellowish; heartwood is deep reddish brown. Cherry begins to darken from the moment it is cut, and continues to darken over time. This distinctive characteristic is one of many reasons cherry has been the choice of fine furniture makers for centuries.

### MAPLE

Maple is a heavy and strong hardwood. Though it typically has a close, uniform grain pattern, there may be unique characteristics such as bird's eye or tiger stripe grain patterns or mineral streaks. Maple is predominantly off-white, although it may contain hues of yellow-brown and pink. It stains and finishes beautifully, making it a popular choice for cabinetry.

### OAK

Oak is a mostly straight-grained, durable hardwood with a medium to coarse texture. The sapwood is white to light brown; heartwood is pinkish red brown. It is sometimes streaked with green, yellow, and black mineral deposits. The open grain produces dramatic and distinct patterns.

### PAINTED

Painted cabinets use a combination of hardwood and engineered materials, such as MDF, to create a beautifully finished product. On painted Salerno & Touraine doors, some of the grain pattern and other characteristics, such as mineral streaks, pitch pockets, checks and pin knots, will remain visible through the painted finish. The finish will take on the texture of birch graining characteristics and will not have a filled smooth surface.

### THERMOFOIL

Rigid vinyl thermofoil is heat- and pressure-bonded to the face and edges of these sculpted doors while the back of the doors are covered with low-pressure white melamine. Heat shields are highly recommended when using thermofoil to minimize potential discoloration and delamination.

### CABINETRY CARE

To keep your Echelon Cabinetry products looking their best for years to come we recommend:

- Clean cabinets as needed with a mild soap and water, and dry well using a lint-free cloth for both washing and drying.
- Wipe up spills, splatters and water spots as they occur.
- Use cleaners and polishes designed for wood cabinets, and clean all surfaces as needed.

## NATURAL CHARACTERISTICS & ENVIRONMENTAL FACTORS

The wood used in Echelon Cabinetry showcases the natural beauty that comes from the inherent characteristics of wood, including:

- Differences in color hues, grain patterns, and textures
- Differences between open- and closed-grain sections
- Visible joint lines, mineral streaks, worm tracks, etc.

Due to nature's infinite variations, it is impossible to include every possible wood characteristic. These variations can occur from cabinet to cabinet and within the same door or drawer front; however, they are considered natural characteristics, not defects. More details about acceptable wood variation and characteristics can be found in the Echelon Cabinetry Visual Quality Standards Training Guide.

As cabinetry products age, the finish may mellow or discolor slightly. The degree of change to the original finish color is affected by your products' exposure to natural and artificial light, smoke, and chemicals. This is a normal characteristic of furniture and cabinetry and not considered a quality defect.

These natural and environmental factors are considered normal characteristics of wood and not defects. Echelon Cabinetry cannot be held responsible for naturally occurring changes experienced by the wood used in your cabinets.

## CUSTOMER ACKNOWLEDGMENT

We want to make certain you are aware of the natural characteristics of wood and their impact on our cabinets as described above. Please indicate your agreement and acceptance with these natural characteristics by signing below:

Customer Signature: \_\_\_\_\_ Date: \_\_\_\_\_

### EchelonCabinetry.com

Trademark owned by ACProducts, Inc.  
©ACPI 01/18 Printed in the United States of America  
Echelon Cabinetry products are certified by the Kitchen Cabinet Manufacturers Association.  
3551 Plano Parkway, Suite 200, The Colony, Texas 75056 800-522-0183



Kitchen Cabinet Manufacturers Association  
Environmental Stewardship Program  
All Products Impact the Environment  
For ESP Program Criteria, Visit [kcma.org](http://kcma.org)

An **acpi** brand

**ECHELON CABINETY PRODUCT DISCLOSURE**  
Characteristics of Painted Finishes on Wood Cabinetry

Echelon Cabinetry painted and glazed finishes are applied using the same quality standards as all of our other finishes. Painted cabinet products have unique characteristics that differ from other finishes but are not considered manufacturer quality defects:

- Wood of all species is hygroscopic, meaning that it is subject to the humidity and temperature of its environment. It will lose or gain moisture and consequently shrink or swell depending on the environment. Even protective coatings cannot prevent this movement; they merely impede the process. As humidity increases, the moisture content increases, and wood expands. As humidity decreases, the moisture content decreases, and the wood will actually shrink. Therefore, painted wood cabinetry should be expected to "shift" during the various shifts in weather throughout the year. Changes in temperature that naturally occur from season to season (especially humidity or prolonged moisture) will cause movement in hardwood products, such as hairline cracks, peeling, or separation. These types of movement are widely accepted as normal in the kitchen cabinet industry and not considered quality defects. Wood may expand and contract differently from cabinet to cabinet and from joint to joint within the same cabinet. Consequently, some cabinet joints may not show any effects of humidity, while others may show varying degrees of cracking or peeling. These shifts may also occur due to the repeated impacts from normal everyday use.
- Painted cabinets use a combination of hardwood and engineered materials, such as MDF, to create a beautifully finished product. On painted Salerno and Touraine doors, some of the grain pattern and other characteristics such as mineral streaks, pitch pockets, checks and pin knots, will remain visible through the painted finish. The finish will take on the texture of birch graining characteristics and will not have a filled smooth surface.
- As painted cabinet products age the finish may mellow or discolor slightly. The degree of change to the original finish color is affected by your products' exposure to natural and artificial light. This is a normal characteristic of painted furniture and cabinetry and not considered a quality defect.

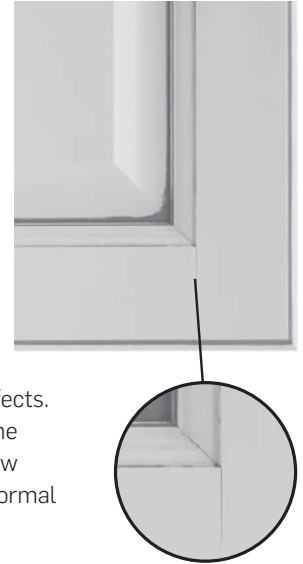

Due to these natural and environmental factors, Echelon Cabinetry cannot be held responsible for naturally occurring changes experienced by the wood in our cabinets.

**CUSTOMER ACKNOWLEDGMENT**

We want to make certain you are aware of the natural characteristics of wood and their impact on our cabinets as described above. Please indicate your agreement and acceptance with these natural characteristics by signing below:

Customer Signature: \_\_\_\_\_

Print Name: \_\_\_\_\_ Date: \_\_\_\_\_

Distributor Signature: \_\_\_\_\_

Print Name: \_\_\_\_\_ Date: \_\_\_\_\_

Order Date: \_\_\_\_\_ Order Number: \_\_\_\_\_

**EchelonCabinetry.com**





# Echelon<sup>®</sup>

CABINETS

High-Quality. Great Value. **Peace of Mind.**

[www.echeloncabinetry.com](http://www.echeloncabinetry.com)

*Proudly Made in America* An **acpi** brand

Trademark owned by ACProducts, Inc.

©ACPI OWNERDOCUMENTSECH 04/18 Printed in the United States of America

Echelon Cabinetry products are certified by the Kitchen Cabinet Manufacturers Association.

**NOTICE:** The product specifications appearing herein supersede and cancel all previous sheets, supplements and addenda, and represent current manufacturing standards and procedures. Echelon Cabinetry reserves the right to make specification changes for continued product improvement.

For aesthetic considerations the furniture and cabinet industries have made veneer on composite panel substrate the standard method of construction for raised panel-in-frame doors in some wood species. Within the Echelon Cabinetry product line, those species include oak, birch, and maple.

**NOTE:** Due to printing limitations, color pictures cannot be guaranteed to exactly match the actual cabinet material.



Kitchen Cabinet Manufacturers Association  
Environmental Stewardship Program  
All Products Impact the Environment  
For ESP Program Criteria, Visit [kcma.org](http://kcma.org)

Echelon Cabinetry is part of the Kitchen Cabinet Manufacturers Association (KCMA) and the National Kitchen and Bath Association (NKBA). Echelon Cabinetry carries the ANSI/KCMA A161.1 quality assurance certification.