

See how quick and easy it is
to measure your kitchen.

MEASURING GUIDE

*Exceptional
Cabinetry Made
Affordable!*

**WHOLESALE CABINET
DISTRIBUTOR FOR**
CONTRACTORS - DEALERS - BUILDERS

**NextDAY
Cabinets**

www.nextdaycabinets.com

BEFORE YOU START

Please be sure to view the Nextdaycabinets.com **Quick Start Measure video** that provides clear step-by-step instructions to help make measuring your kitchen simple and easy.

WATCH VIDEO »



www.nextdaycabinets.com

CHANTILLY SHOWROOM

3920 Stonecroft Blvd Suite D, Chantilly, VA, 20151
Ph: 703-291-8935 / Fx: 800-866-3486

ALEXANDRIA SHOWROOM

5655-E General Washington Dr., Alexandria, VA 22312
Ph: 703-348-6181 / Fx: 800-866-3486

BELTSVILLE SHOWROOM

11712 Baltimore Ave Ste A, Beltsville, MD 20705
Ph: 301-985-2730 / Fx: 301-985-2730

IT'S EASY

Our Measure Guide is easy to use (yes, it really is easy) and helps collect the basic information to help you and your designer start your design. This does not have to be a work of art but just a clear and accurate drawing of your space. If you want to use the attached graph paper, that's great. If not, then all we need is your drawing. We're here to help – please call **703-291-8935** with any questions.

1

Step 1: Your Kitchen Shape

Draw your kitchen as a box showing all the walls that you think will have cabinets. Be sure to include any major structural features or obstacles.

2

Step 2: Draw It Out

Mark any openings such as windows and doorways. Be sure to include radiators or other obstacles that affect where cabinets can be installed. Now, label all the openings in your kitchen. In this sketch we'll use areas A thru I. Record these letters as a key on your sketch.

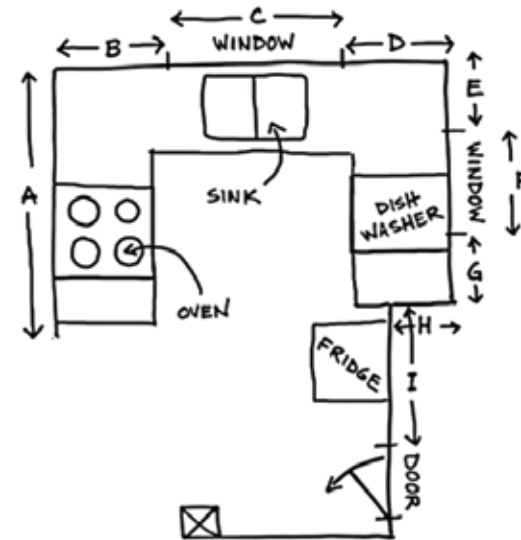

KEY

A =	100"
B =	36"
C =	72"
D =	36"
E =	18"
F =	48"
G =	18"
H =	12"
I =	60"

IT'S EASY

3

Step 3: Measure

Now it's time to get out the tape measure. Measure all the openings, from outside edge to outside edge, and fill in the key. If you're uncomfortable with precise measurements feel round to the nearest inch. Remember this is just to get started, free to round to the nearest inch. Remember this is just to get started, your designer will confirm details later.

4

Step 4: Your Layout

Most people already have a good idea of where the major items will go in their kitchen. Feel free to draw your ideas of what you would like and include the placement of your sink and appliances.

5

Pictures of Your Kitchen

What can really help your designer is to take 'before' pictures of your kitchen and send them along with your measurements.

That's it! You're done! It is that easy to measure your kitchen.



YOUR INFO & SKETCH

www.nextdaycabinets.com



Name ----- Door Style -----
Phone ----- Designer -----
Email ----- Kitchen ceiling height (in inches) -----

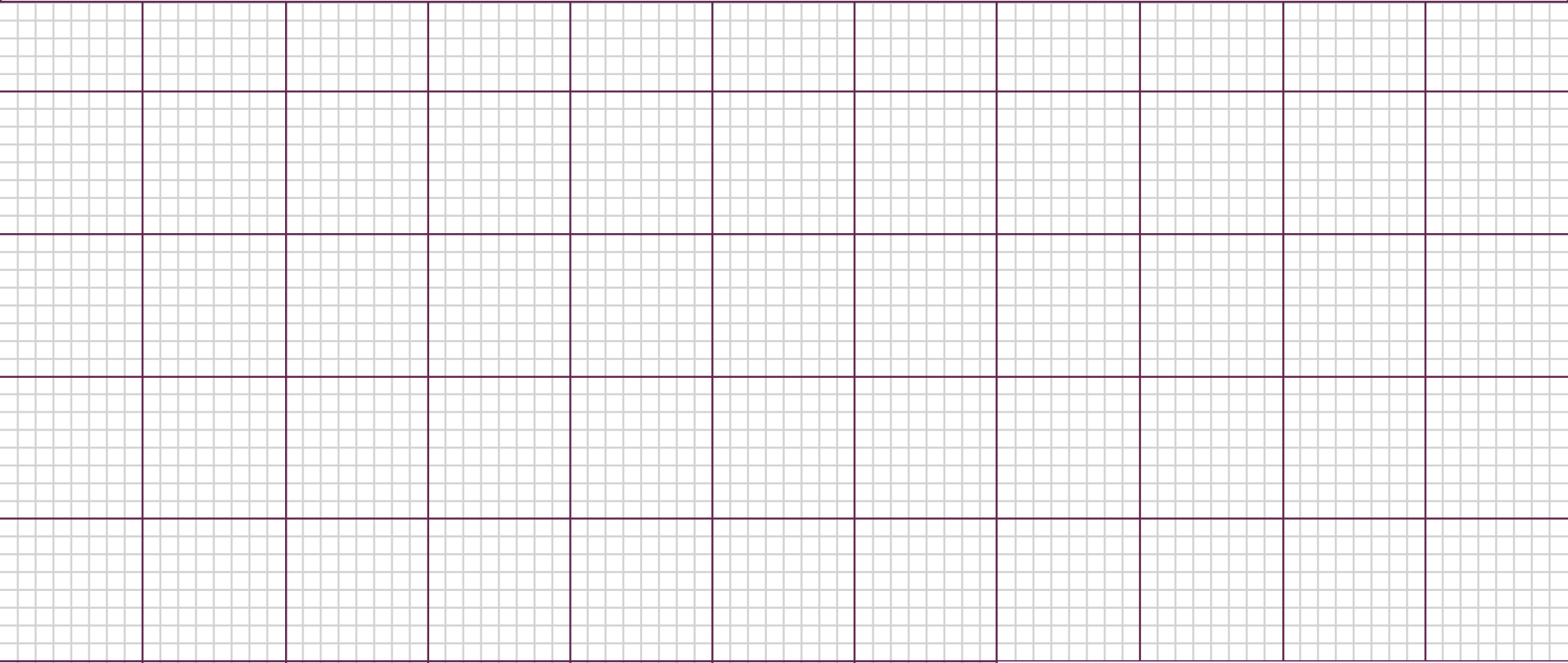

Drawing does not have to be perfect or to scale – just neat. Feel free to use any paper you want.

www.nextdaycabinets.com

CHANTILLY SHOWROOM

3920 Stonecroft Blvd Suite D, Chantilly, VA, 20151
Ph: 703-291-8935 / Fx: 800-866-3486

ALEXANDRIA SHOWROOM

5655-E General Washington Dr., Alexandria, VA 22312
Ph: 703-348-6181 / Fx: 800-866-3486

BELTSVILLE SHOWROOM

11712 Baltimore Ave Ste A, Beltsville, MD 20705
Ph: 301-985-2730 / Fx: 301-985-2730

SEND IT TO CLIQ

You're almost done. Just forward your information and measurements form to us.



EMAIL

info@nextdaycabinets.com

15 mb max per email, if larger please submit multiple emails.



SMART PHONE

Take pictures of the form and your drawing and email them to:

info@nextdaycabinets.com



WEBSITE

Use the web form at

www.nextdaycabinets.com/measuring-guide



FAX

877-675-4394



Don't forget pictures!

A picture is worth a thousand words.
Send them along with your drawing.

www.nextdaycabinets.com

CHANTILLY SHOWROOM

3920 Stonecroft Blvd Suite D, Chantilly, VA, 20151
Ph: 703-291-8935 / Fx: 800-866-3486

ALEXANDRIA SHOWROOM

5655-E General Washington Dr., Alexandria, VA 22312
Ph: 703-348-6181 / Fx: 800-866-3486

BELTSVILLE SHOWROOM

11712 Baltimore Ave Ste A, Beltsville, MD 20705
Ph: 301-985-2730 / Fx: 301-985-2730