



**SPECIAL
VANITY ORDER
PROGRAM**

*Exceptional
Cabinetry Made
Affordable!*

**WHOLESALE CABINET
DISTRIBUTOR FOR**
CONTRACTORS - DEALERS - BUILDERS

**NextDAY
Cabinets**

www.nextdaycabinets.com

1 CHOOSE A VANITY CABINET DOOR STYLE:



CYOF Country Oak Classic	KM Cinnamon Glaze	KC Cherry Glaze	KE K. Espresso	MR Sienna Rope	AK Shakertown	AW Ice White Shaker	AP Paper Shaker	GW Gramercy White	GM Gramercy Midnight	SB Signature Brownstone	SL Signature Pearl	PC Pacifica	TD Downtown Dark	TW Uptown White
---------------------------------------	--------------------------------	------------------------------	--------------------------	-----------------------------	-------------------------	----------------------------------	------------------------------	--------------------------------	-----------------------------------	--------------------------------------	---------------------------------	-----------------------	-------------------------------	------------------------------

2 SELECT VANITY CABINETS YOU NEED: - 21" D x 34 1/2" H

DRAWERS BANKS

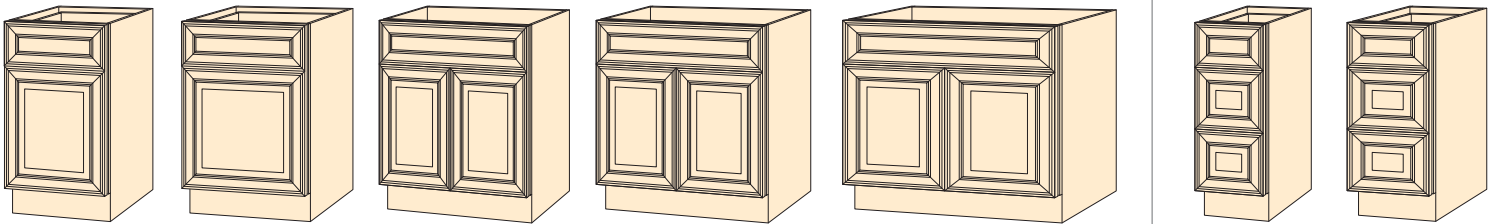

18" WIDE Vanity Base	21" WIDE Vanity Base	24" WIDE Vanity Base	30" WIDE Vanity Base	36" WIDE Vanity Base	12" WIDE Vanity Base	15" WIDE Vanity Base
--------------------------------	--------------------------------	--------------------------------	--------------------------------	--------------------------------	--------------------------------	--------------------------------

FIXED SIZE VANITY CABINET BASES: - 21" D x 34 1/2" H with 12" W Drawers

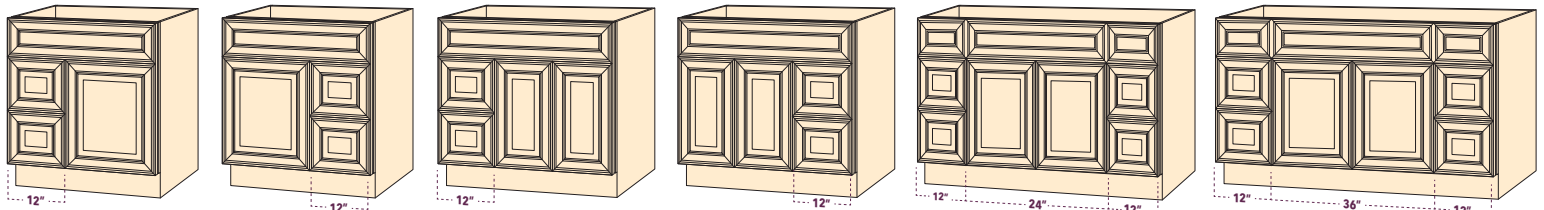

30" WIDE Drawers - Left	30" WIDE Drawers - Right	36" WIDE Drawers - Left	36" WIDE Drawers - Right	48" WIDE Drawers - Left, Right	60" WIDE Drawers - Left, Right
-----------------------------------	------------------------------------	-----------------------------------	------------------------------------	--	--

COUNTER HUTCH:

LINEN CABINETS & DOUBLE DOOR:

DRAWERS:

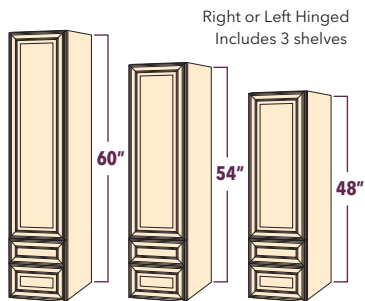

18" W X 12" D WITH 2 DRAWERS

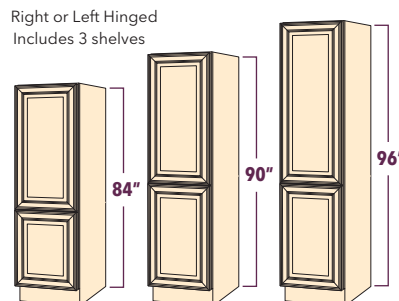

18" W X 21" D WITH SHELVES

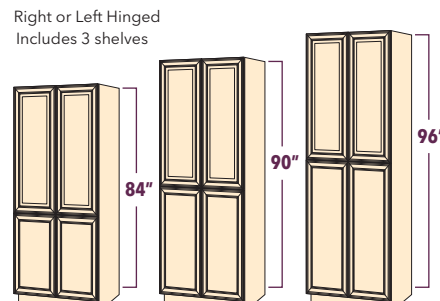

24" W X 21" D WITH SHELVES



**30" VANITY
DRESSING
DRAWER**

Right or Left Hinged
Includes 3 shelves

30" W X 21" D X 3" H

SPECIAL VANITY ORDER PROGRAM

DELIVERED TO YOUR NEXTDAY STORE IN 5 DAYS

3 CHOOSE VANITY CABINET ACCESSORY OPTIONS:

VANITY CABINET FILLERS (can be used between cabinets, against walls, or as a decorative accent)

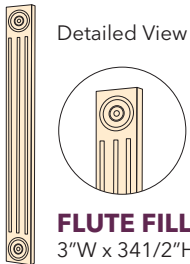

Detailed View

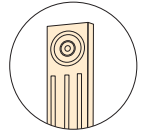

FLUTE FILLER
3"W x 34 1/2"H

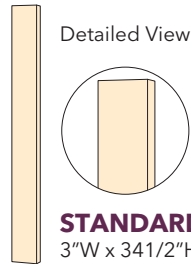

Detailed View

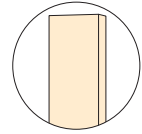

STANDARD FILLER
3"W x 34 1/2"H

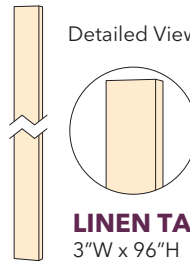

Detailed View

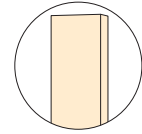

LINEN TALL FILLER
3"W x 96"H

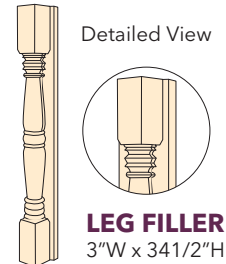

Detailed View

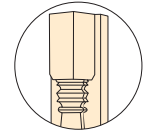

LEG FILLER
3"W x 34 1/2"H

TOE KICKS

Add to Vanity Base for a customized furniture look

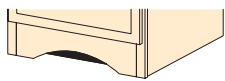

VALANCE TOE KICK

48"W X 4.5"H

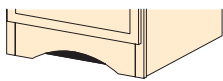

VALANCE TOE KICK

54"W X 4.5"H

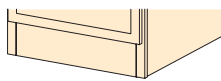

STANDARD TOE KICK

96"W X 4 1/2"H

ACCESSORIES (Crown Molding and Laundry Hamper Kit)



HUTCH CROWN MOLDING
96" X 2 1/4"

(Order for use with hutch and linen cabinets)



LINEN CROWN MOLDING
96" X 2 1/4"

(Order for use with hutch and linen cabinets)



VANITY SCRIBE MOLDING
96" X 3/4"

(Use to fill in small gaps where cabinets meet the wall)

SELECT YOUR DECORATIVE WALL OPTIONS *Crown Molding Included Includes Two Shelves

BATH STORAGE

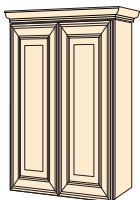

24"WIDE
9"D X 30"H*

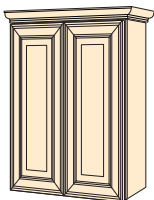

27"WIDE
9"D X 30"H*

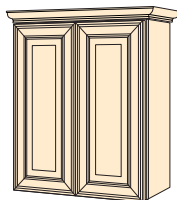

30"WIDE
9"D X 30"H*

WALL HUTCH STORAGE

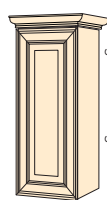

15"WIDE
9"D X 30"H*

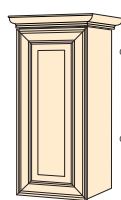

18"WIDE
9"D X 30"H*

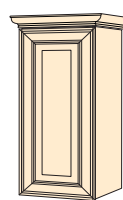

21"WIDE
9"D X 30"H*

FLUTE MIRROR WITH FILLERS



FLUTE MIRROR
24" TO 60" WIDE

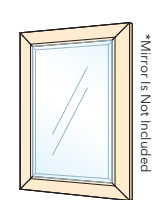

FLAT MIRROR
24" TO 60" WIDE

4 DESIGN & FINISHING TIPS

PLANNING THE SPACE

Ensure your bathroom is properly measured and reviewed prior to finalizing your cabinet order. When designing your bathroom, consider room size and elements such as windows, doors, toilet location, plumbing, electrical outlets and door clearances, as they will influence your layout and cabinet selections.

ACCESSORIES

Crown Molding, Vanity Dressing Drawers, Linen Cabinets, Hutches and Laundry Hamper Kits, add detail to enhance the appearance and maximize storage for your bathroom.

TOE KICKS AND FILLERS

Toe Kicks provide an elegant furniture look to your bathroom cabinets and are offered in all finishes and styles. When designing your layout, Fillers can be added to balance out your available area and fill space.

CABINET LAYOUT

When cabinets are placed next to walls, a filler must be used to separate the cabinets from the wall to prevent the doors and drawers from rubbing.

SINK LOCATION

Keep in mind that sinks can only be placed on Vanity Bases, and not Drawer Banks. Sinks cannot be placed on 18" wide Vanity base.

www.nextdaycabinets.com

HERNDON SHOWROOM

13850 McLearen Rd, Herndon, VA 2017
Ph: 703-291-8935 / Fx: 800-866-3486

ALEXANDRIA SHOWROOM

5655-E General Washington Dr., Alexandria, VA 22312
Ph: 703-348-6181 / Fx: 703-348-8059

BELTSVILLE SHOWROOM

11712 Baltimore Ave Ste A, Beltsville, MD 20705
Ph: 301-985-2730 / Fx: 301-985-2730

CABINET LAYOUT WORKSHEET



Use this scaled working grid to design your bathroom plan.
A sample diagram is shown below for reference. A store associate can assist with your selection and ordering process.

NOTES:

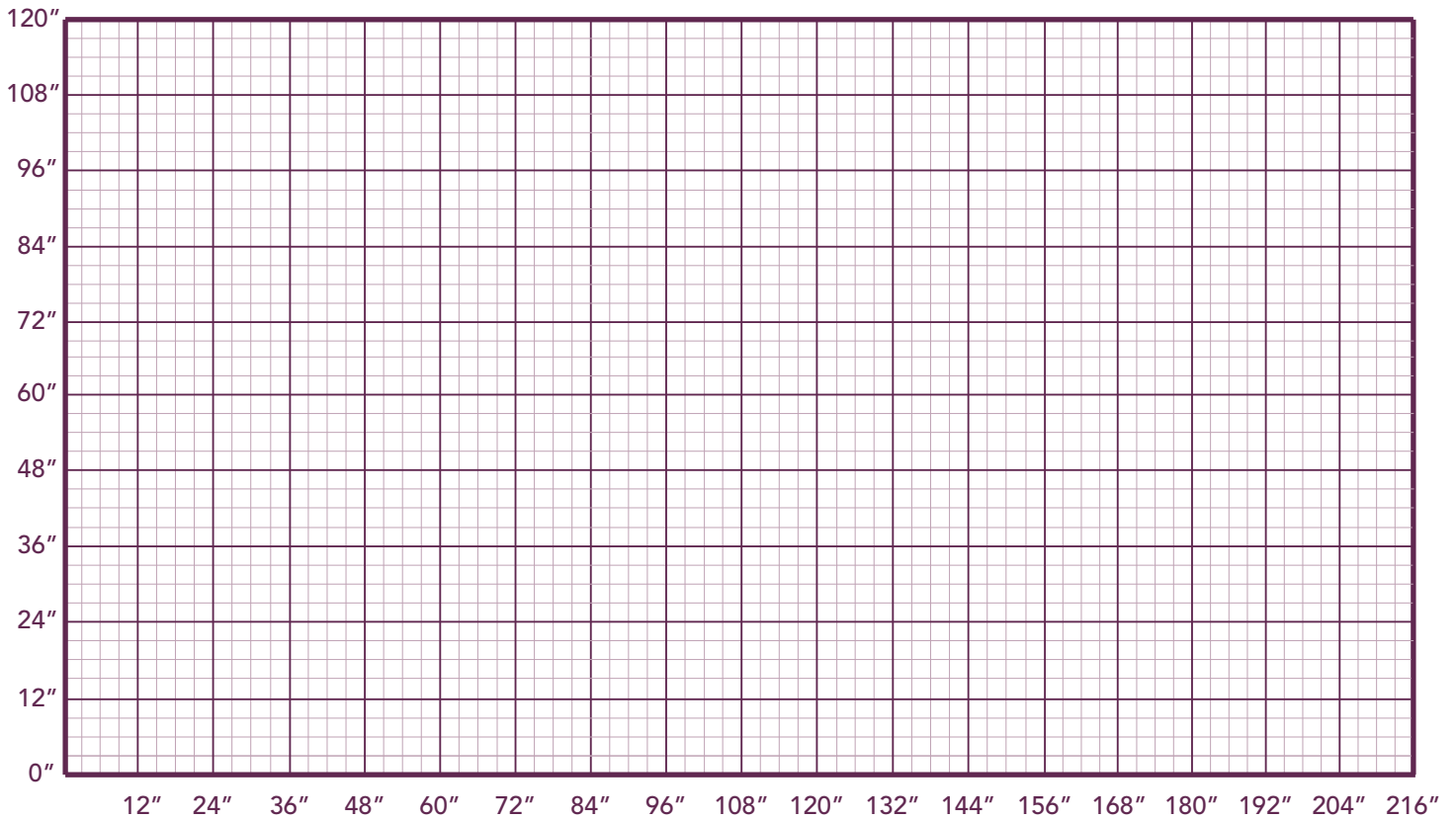
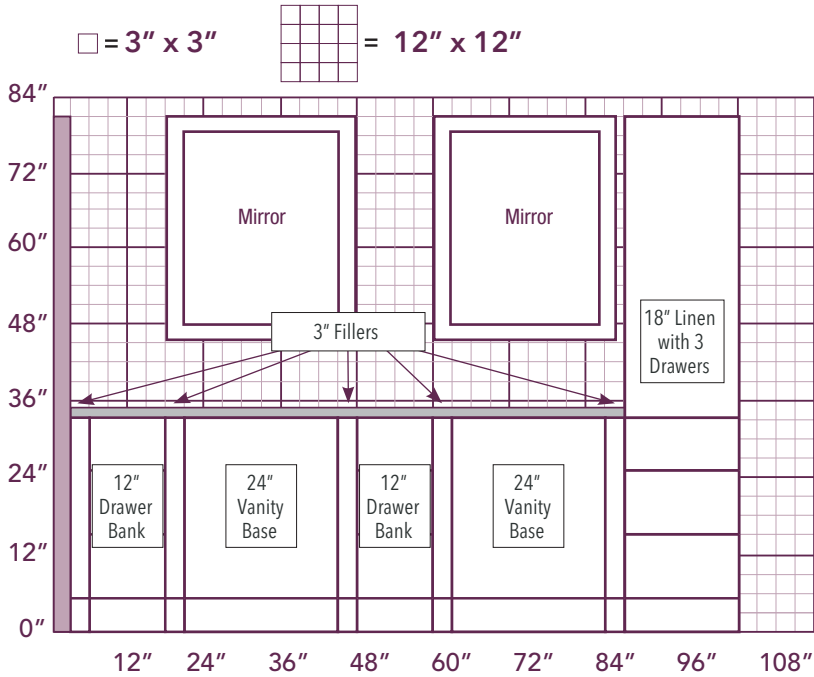

www.nextdaycabinets.com

HERNDON SHOWROOM
13850 McLearen Rd, Herndon, VA 2017
Ph: 703-291-8935 / Fx: 800-866-3486

ALEXANDRIA SHOWROOM
5655-E General Washington Dr., Alexandria, VA 22312
Ph: 703-348-6181 / Fx: 703-348-8059

BELTSVILLE SHOWROOM
11712 Baltimore Ave Ste A, Beltsville, MD 20705
Ph: 301-985-2730 / Fx: 301-985-2730